

8 Finney Drive, Chorlton Green, Manchester, M21 9DS



**JP&Brimelow**  
ESTATE AGENTS



4 2 2 D

\*\*\*VIDEO TOUR AVAILABLE\*\*\* A light and immaculately-presented, FOUR BEDROOM, link-detached property situated on this highly popular cul-de-sac located off Crossland Road in a central Chorlton Green position.

Within walking distance to good local schools, Chorlton Nature Reserve, the Cafe' Bar Society on Beech Road and all of the amenities available in Chorlton.

This deceptively spacious accommodation consists of an entrance hall, a beautiful fully fitted kitchen/dining room with space for all the family, a large living room with french doors opening to a well maintained rear garden, an inner hallway/utility area leading to a three-piece shower room and a downstairs double bedroom/playroom.

Whilst to the first floor there is a landing leading to two excellent-sized double bedrooms, a fitted modern three-piece shower room, and a further bedroom that is currently used as a dressing room.

The property is warmed by gas central heating, has off-street parking for multiple vehicles and a rear enclosed low maintenance garden.

Would ideally suit a family or a professional couple and internal inspection is highly recommended due to the location with fantastic primary schools on your doorstep.

£550,000





## EPC Chart

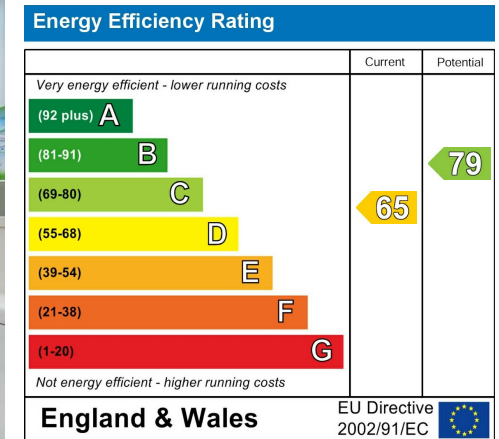

Tenure: Freehold Council Tax Band: D

### Ground Floor



### First Floor

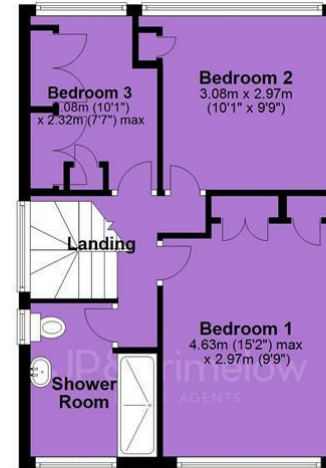

JP & Brimelow Estate Agents Ltd  
 430 Barlow Moor Road, Manchester, M21 8AD  
 Tel: 0161 8822233  
 E: sales@jpbrimelow.co.uk www.jpandbrimelow.co.uk



**JP & Brimelow**  
 ESTATE AGENTS

NOTICE: JP & Brimelow Estate Agents Ltd for themselves and for the vendors or lessors of this property whose agents they are give notice that:

- (i) the particulars are set out as a general outline only for the guidance of intending purchasers or lessees, and do not constitute, nor constitute part of, an offer or contract;
- (ii) all descriptions, dimensions, references to the condition and necessary permissions for use and occupation, and other details are given in good faith and are believed to be correct but any intending purchasers or tenants should not rely on them as statements or representations of fact but must satisfy themselves by inspection or otherwise as to the correctness of each of them;
- (iii) no person in the employment of JP & Brimelow Estate Agents Ltd has any authority to make or give any representation or warranty whatever in relation to this property.

@jpandbrimelowstateagents

@jpandbrimelow

